

BOLLARD PROTECTION MEASURES

ELECTRICAL EQUIPMENT REQUIRES CLEARANCES OR SETBACKS ON ALL SIDES FROM VEHICULAR TRAFFIC. THIS INCLUDES DRIVEWAYS, ALLEYS, PARKING LOTS, ETC. BOLLARDS WILL BE INSTALLED BY THE DEVELOPER WHEN ELECTRICAL EQUIPMENT IS LOCATED IN AREAS WHERE LESS THAN THE RECOMMENDED CLEARANCES EXIST OR IS AT RISK TO VEHICULAR DAMAGE.

BOLLARD POSITIONS AND CRITERIA

- 10' CLEAR ZONE IN FRONT OF ALL EQUIPMENT DOORS
- 6" MINIMUM DISTANCE FROM THE CONCRETE PAD
- 3' MINIMUM DEPTH

RESIDENTIAL:

- 4" MINIMUM DIAMETER
- 3' MINIMUM HEIGHT

COMMERCIAL:

- 6" MINIMUM DIAMETER
- 4' MINIMUM HEIGHT

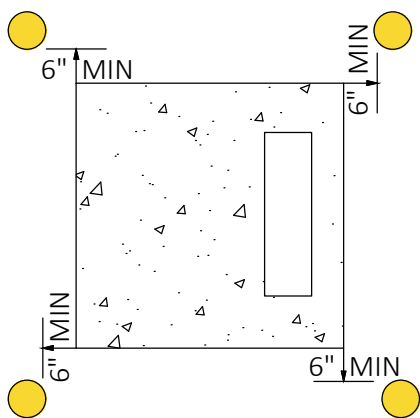

TYPICAL LAYOUT

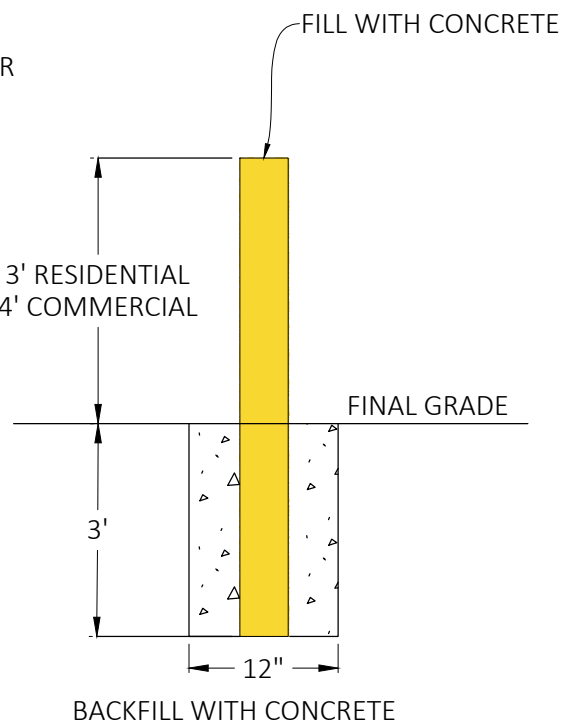

BACKFILL WITH CONCRETE

NOTES:

- 1) QUANTITY AND LOCATION OF BOLLARDS REQUIRED IS SUBJECT TO SITE CONDITIONS. LPC OPERATIONS WILL SPECIFY PLACEMENT.
- 2) FOR EQUIPMENT CLEARANCES REFER TO DETAIL 700-02

ELECTRIC SERVICES

CALL 1-800-922-1987 TO OBTAIN UTILITY LOCATES

NOT TO SCALE



CITY OF
LONGMONT
COLORADO

1100 S SHERMAN ST
LONGMONT, CO 80501

BOLLARD INSTALLATION

PHONE: 303-651-8386
FAX: 303-651-8796

Revision #:
Approved by:
Date Approved: 2024
File: UG Drawings_2024.dwg
DETAIL

700-18